



## MOUNTING INSTRUCTIONS

### 2321-0062 SPORTSHIELD PLATE ONLY MOUNTING KIT

HONDA VT 1100 SABRE/VT 750 ACE DLX

## ! WARNING

Read and follow these directions carefully.

During installation, make certain that when turning the forks, there can be no interference with wiring or cables AND, that the windshield can not hit the gas tank, through the windshield's full range of adjustment.

This is a detachable windshield, ALWAYS make sure the Locking Mechanism is Fully Engaged after installing the windshield!

The improper installation of this kit and related components could result in serious injury or death.

1. Cover gas tank and front fender with towels to avoid damage during installation.

2. Install the windshield mounting plates onto the windshield, using the bolts that are pre-assembled on the mounting plates. The Santoprene grommets should be inserted through the holes in the windshield so that the flat round part lies flat on each side of the plastic. *NOTE: Tabs will point in towards headlight when properly installed.* (see Figure 1)

3. Install the windshield by placing the lower slots into the lower mounting bushings. Slip the upper slots into the upper mounting bushings and gently but firmly seat the slots into place. Lock the locking mechanism into place. (see figure 2 and 3)

4. Tighten all mounting bolts. Adjust the height, angle and alignment of the windshield and tighten **ALL** bolts.

**Note:** This is a detachable windshield, ALWAYS make sure the Locking Mechanism is Fully Engaged after installing the windshield! (see figure 4)

## CAUTION

### IMPORTANT CARE AND CLEANING INSTRUCTIONS

Memphis Shades Windshields and Lowers are made of Lucite® acrylic, and will last for years with proper care. Clean your windshield with plenty of soapy water — mild dishwashing liquid is best — and a soft cotton cloth. Use your bare hand to feel and dislodge bugs, or cover with a wet soapy towel and let it soak. Don't use paper towels and don't scrape with anything. Small scratches can be removed with NOVUS # 2.

NEVER use any glass cleaning products, petroleum based chemicals, or cleaning agents with ammonia, bleach or any other harsh chemicals. This includes (but not limited to) RainX, brake fluid, acetone, paint thinner, benzene and gasoline. "If it hurts your nose, it will hurt the plastic."

**Glass cleansing agents will cause severe damage to your windshield, and will void your warranty.**

*NOTE:* At certain times of the day the Sunlight can reflect off the curvature of a windshield and cause extreme heat build-up on motorcycle instruments and instrument panel. Take care when parking. Park facing the sun, place an opaque object over the instruments or adjust the windshield to avoid reflections.

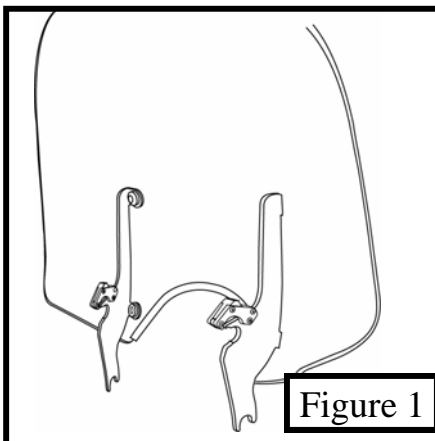

Figure 1

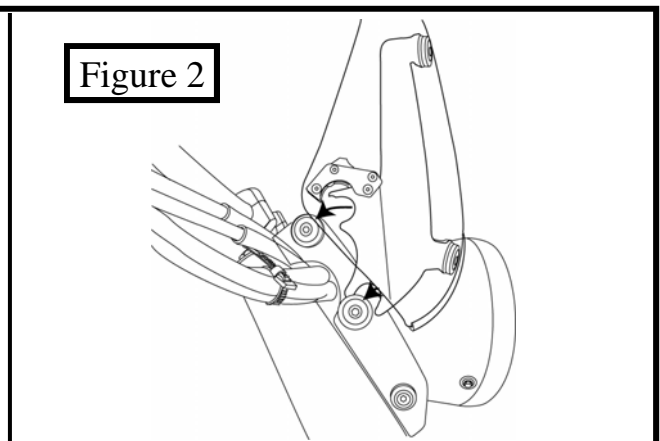

Figure 2



# MOUNTING INSTRUCTIONS

## 2321-0062 SPORTSHIELD PLATE ONLY MOUNTING KIT HONDA VT 1100 SABRE/VT 750 ACE DLX

PART #	DESCRIPTION	QTY.
M8824	MOUNTING INSTRUCTIONS	1
M1155	LEFT SPORTS MOUNTING PLATE	1
M1156	RIGHT SPORTS MOUNTING PLATE	1
R322C/T	LATCH ASSEMBLY	2
R334	6-32 X 3/8" FLAT HEAD SS SCREW	8

PART #	DESCRIPTION	QTY.
R326	SS SPRING	2
M543	SANTOPRENE GROMMET	4
M504	SOCKET SHOULDER WASHER	4
M302	1/4"-20 X 1/2" SOCKET HEAD CAP SCREW	4
M505	BUTTON NUT	4

**Figure 3**

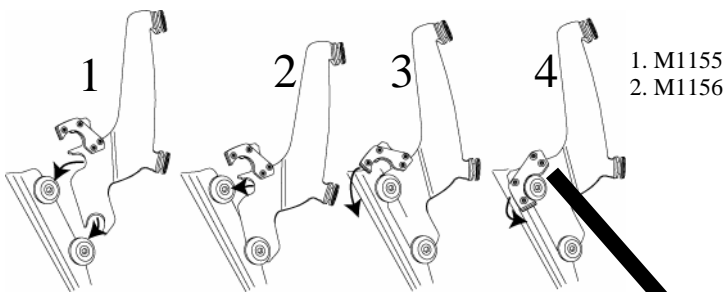

1. Place lower slot into lower bushing. 2. Rotate top slot into place. 3. & 4. Secure locking Mechanism.

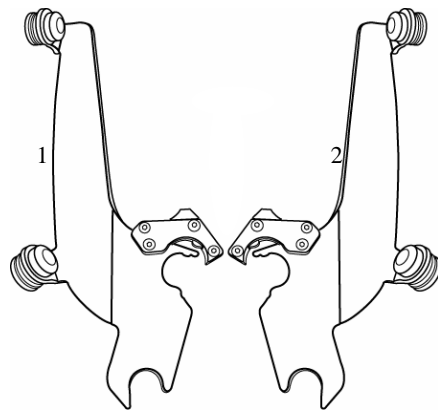

2321-0062 SPORTS PLATE ONLY KIT

**Figure 4**

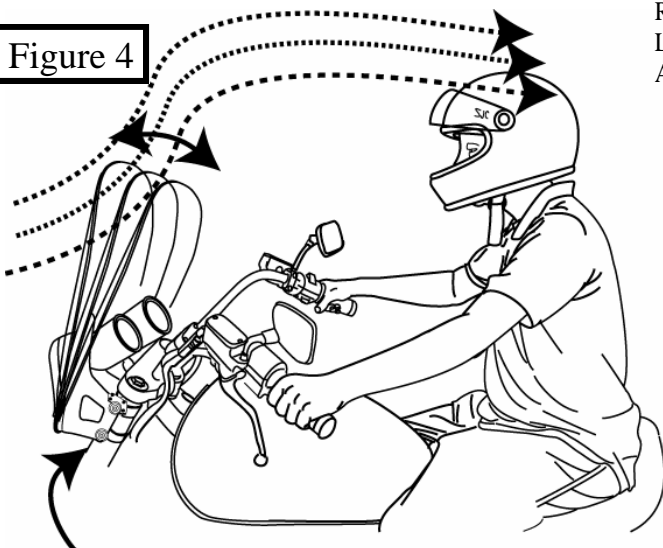

Loosen Allen Bolt to adjust angle, then re-tighten Allen Bolt.

R322C/T  
LATCH  
ASSEMBLY

**NOT CORRECT**

**CORRECT**  
**Fully engaged  
Locking mechanism**

Memphis Shades warrants all product components, metal and plastic, against defects in materials and workmanship for 24 months.

**FOR PARTS AND WARRANTY HELP, CONTACT:**

MEMPHIS SHADES  
P. O. Box 429  
Rossville, TN 38066  
(901) 853-0293

Visit us on the web at [www.memphisshades.com](http://www.memphisshades.com) or  
you can also reach us by email:  
[customerservice@memphisshades.com](mailto:customerservice@memphisshades.com)