



# MOUNTING INSTRUCTIONS

2321-0115 YAMAHA ROAD STAR FAIRING PLATES ONLY '99—'08

## ! WARNING

Read and follow these directions carefully. During installation, make sure that the fairing and hardware do not interfere with any cables or wiring when the forks are turned all the way in either direction. Also make sure, through the full range of adjustment, that the fairing and hardware do not hit the tank.

This is a detachable fairing, **ALWAYS** make sure the Locking Mechanism is Fully Engaged after installing the fairing! The improper installation of this kit and related components could result in serious injury or death.

- Additional tools required that are not included in the kit. 7/16" or 11mm wrench, 10mm wrench and a blunt pry tool.
1. Cover gas tank and front fender with towels to avoid damage during installation.
  2. Install the two mounting plates on the fairing using the acorn nuts and washers supplied with the fairing (Fig-1).
  3. Install the fairing by placing the lower slots into the lower mounting bushings. Slip the upper slots into the upper mounting bushings and gently but firmly seat the slots into place. Lock the locking mechanism into place, (Fig-2)
  4. Adjust the height, angle and alignment of the fairing and tighten **ALL** bolts.

**Note:** This is a detachable fairing, **ALWAYS** make re the Locking Mechanism is Fully Engaged after installing the fairing! (see figure 3)

Fig 1

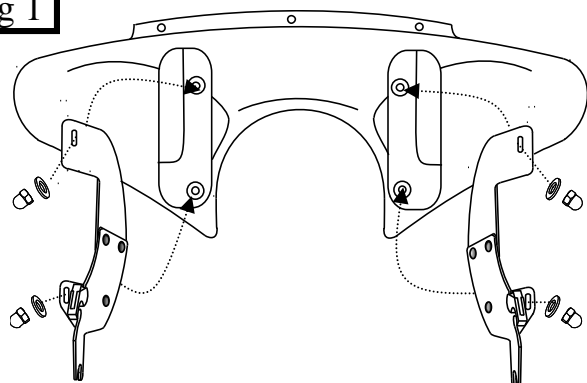

## CAUTION

### IMPORTANT CARE AND CLEANING INSTRUCTIONS

Memphis Shades Fairings and Loweres are made of Lucite® acrylic, and will last for years with proper care. Clean your fairing with plenty of soapy water — mild dishwashing liquid is best — and a soft cotton cloth. Use your bare hand to feel and dislodge bugs, or cover with a wet soapy towel and let it soak. Don't use paper towels and don't scrape with anything. Small scratches can be removed with NOVUS # 2. **NEVER** use any glass cleaning products, petroleum based chemicals, or cleaning agents with ammonia, bleach or any other harsh chemicals. This includes (but not limited to) RainX, brake fluid, acetone, paint thinner, benzene and gasoline. "If it hurts your nose, it will hurt the plastic."

**Glass cleansing agents will cause severe damage to your fairing, and will void your warranty.**

**NOTE:** At certain times of the day the Sunlight can reflect off the curvature of a fairing and cause extreme heat build-up on motorcycle instruments and instrument panel. Take care when parking. Park facing the sun, place an opaque object over the instruments or adjust the fairing to avoid reflections.

### 2321-0114 KIT

Part #	Description	Qty
M8898	Mounting Instructions	1
M1237	Clutch side plate, black	1
M1238	Throttle side plate, black	1

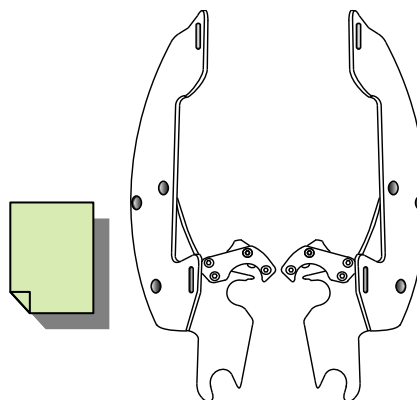



# MOUNTING INSTRUCTIONS

2321-0115 YAMAHA ROAD STAR FAIRING PLATES ONLY '99—'08

Figure 2

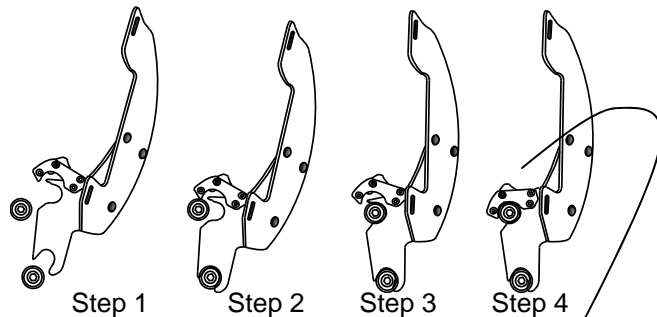

1. Place lower slot into lower bushing. 2. Rotate top slot into place. 3. & 4. Secure locking Mechanism.

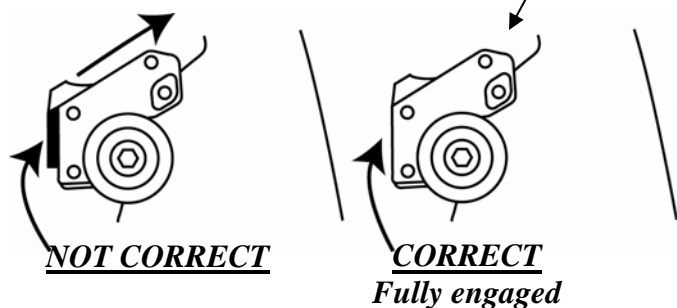

Memphis Shades warrants all product components, metal and plastic, against defects in materials and workmanship for 24 months.

**FOR PARTS AND WARRANTY HELP, CONTACT:**

MEMPHIS SHADES  
P. O. Box 429  
Rossville, TN 38066  
(901) 853-0293

Visit us on the web at [www.memphisshades.com](http://www.memphisshades.com) or  
You can also reach by email:  
[customerservice@memphisshades.com](mailto:customerservice@memphisshades.com)