



MOUNTING INSTRUCTIONS

2320-0022 Detachable Sportshield Mounting Kit for HD Covered Forks with Light Bar

! WARNING

Read and follow these directions carefully. During installation, make sure that the windshield and hardware do not interfere with any cables or wiring when the forks are turned all the way in either direction. Also make sure, through the full range of adjustment, that the windshield and hardware do not hit the tank.

This is a detachable windshield, ALWAYS make sure the Locking Mechanism is Fully Engaged after installing the windshield!

The improper installation of this kit and related components could result in serious injury or death.

Additional tools required, that are not included in this kit. 7/16" or 11mm wrench.

1. Cover gas tank and front fender with towels to avoid damage during installation.

2. Remove the two original upper Light Bar bolts located on the sides of the forks, also temporarily remove the steel spacers behind the Light Bar frame. Replace the bolts with the new longer upper mount bushing assemblies (use the 1-3/4" long bolt assemblies) and re-install the original steel spacers behind the Light Bar frame. (See figure 1). **Note:** Additional 1 1/2" bolts are included for some applications.

3. Remove the two lower Light Bar mounting bolts located on both sides of the forks. Install the new lower bolt bushing assembly. (See figure 1) Repeat step 2 and 3 on the opposite side.

4. Install the two mounting plates onto the windshield, using the bolts that are pre-assembled on the mounting plates. The Santoprene Grommets should be inserted through the holes in the windshield so that the flat round part of the Grommet lies flat on each side of the windshield. *Tabs point in towards the headlight.* (See Figure 2)

5. Slip the windshield mounting plates and windshield onto the upper and lower bushing assemblies, (see figure 3 and 5) and secure the left and right side locking mechanism.

6. Adjust the height, angle and alignment of the windshield and tighten *ALL* bolts.

Note: This is a detachable windshield, ALWAYS make sure the Locking Mechanism is Fully Engaged after installing the windshield! (see figure 5)

CAUTION

IMPORTANT CARE AND CLEANING INSTRUCTIONS

Memphis Shades Windshields and Lowers are made of Lucite® acrylic, and will last for years with proper care. Clean your windshield with plenty of soapy water — mild dishwashing liquid is best — and a soft cotton cloth. Use your bare hand to feel and dislodge bugs, or cover with a wet soapy towel and let it soak. Don't use paper towels and don't scrape with anything. Small scratches can be removed with NOVUS # 2.

NEVER use any glass cleaning products, petroleum based chemicals, or cleaning agents with ammonia, bleach or any other harsh chemicals. This includes (but not limited to) RainX, brake fluid, acetone, paint thinner, benzene and gasoline. "If it hurts your nose, it will hurt the plastic."

Glass cleansing agents will cause severe damage to your windshield, and will void your warranty.

NOTE: At certain times of the day the Sunlight can reflect off the curvature of a windshield and cause extreme heat build-up on motorcycle instruments and instrument panel. Take care when parking. Park facing the sun, place an opaque object over the instruments or adjust the windshield to avoid reflections.

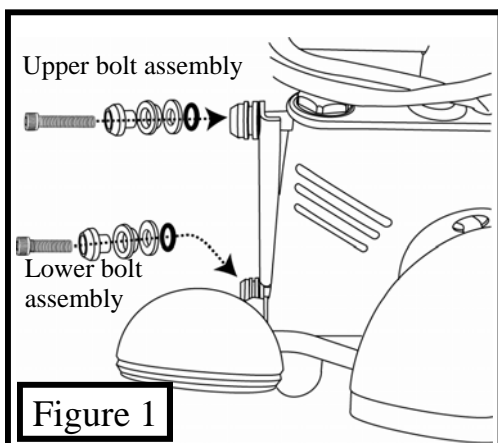

Figure 1

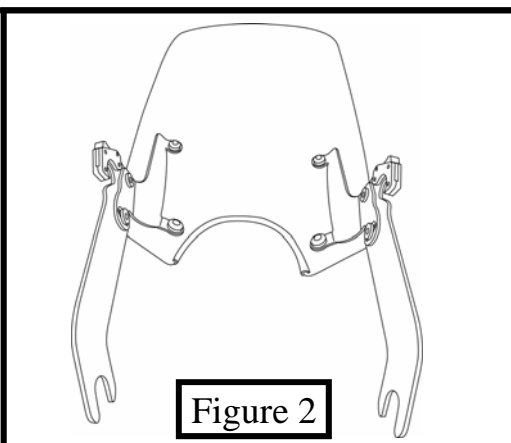

Figure 2

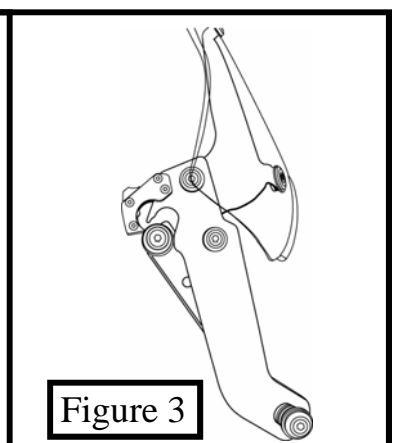

Figure 3



MOUNTING INSTRUCTIONS

2320-0022 Detachable Mounting Kit Sportshield for H-D Covered Forks with Light Bar

Part #	Description	Qt	Part #	Description	Qt
M8923	Instructions	1	M301	1/4"- 20 x 3/8 SS Socket head cap screw	4
M1149	Left mounting plate	1	M302	1/4"- 20 x 1/2 SS Socket head cap screw	4
M1150	Right mounting plate	1	M504	Socket shoulder washer	4
R323	Bushing assembly (2 part)	4	M543	Santoprene grommet	4
R324	#207 EPDM O Ring	4	M505	Button nut	4
M334	5/16"-24 x 1 1/4 SS Socket head cap screw	2	R322CTS	Slanted latch assembly	2
M576	7/8" Beveled socket washer	4	R326	Latch spring	2
R339	5/16"-24 x 1 3/4 SS Socket head cap screw	2	R334	Latch screw	8
M578	Self adhesive plastic washer	4	R340	1/4" Short arm allen wrench	1
R329	Slot nut	4	M310	3/16" Short arm allen wrench	1
M501	3/4" Beveled socket washer	4	M313	3/16" Allen wrench cover	1
M361	5/16"-24 x 1 1/2 SS Socket head cap screw	2			

BUSHING ASSEMBLY

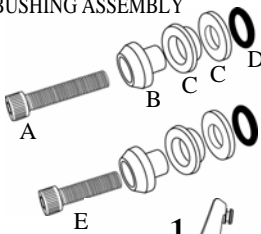

- A. R339
- B. M576
- C. R323
- D. R324
- E. M334

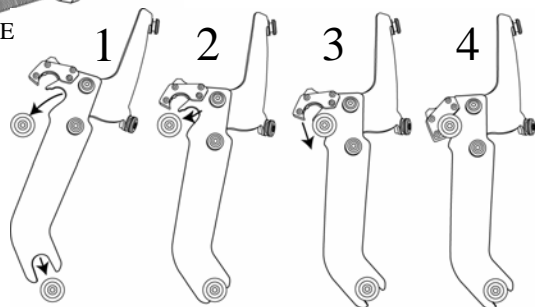

1. Place lower slot into lower bushing. 2. Rotate top slot into place. 3. & 4. Secure locking Mechanism.

Figure 5

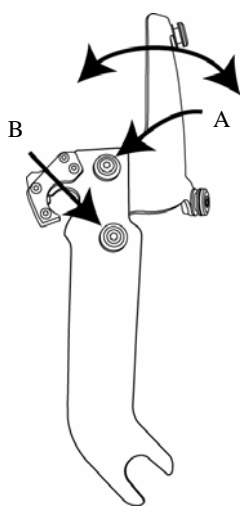

Loosen Allen Bolts A & B to adjust angle, then re-tighten Allen Bolts.

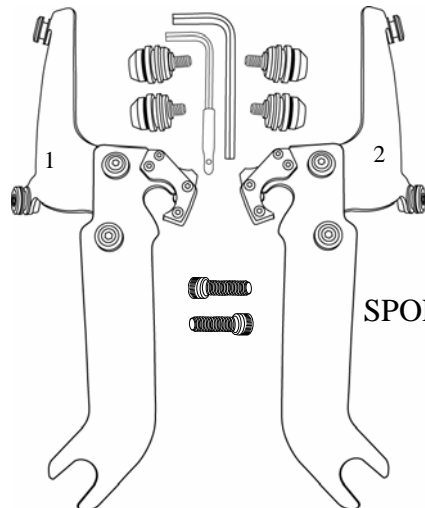

2320-0022
SPORTSHIELD KIT

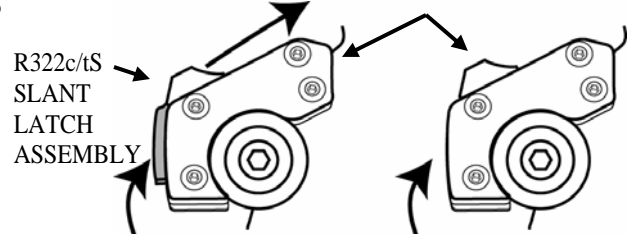

NOT CORRECT
CORRECT
Fully engaged Locking mechanism

Memphis Shades warrants all product components, metal and plastic, against defects in materials and workmanship for 24 months.

FOR PARTS AND WARRANTY HELP, CONTACT:
MEMPHIS SHADES
P. O. Box 429
Rossville, TN 38066
(901) 853-0293

Visit us on the web at www.memphisshades.com or you can also reach us at customerservice@memphisshades.com